

IDAN-DM6210-62S

DIMENSIONS AND PINOUT

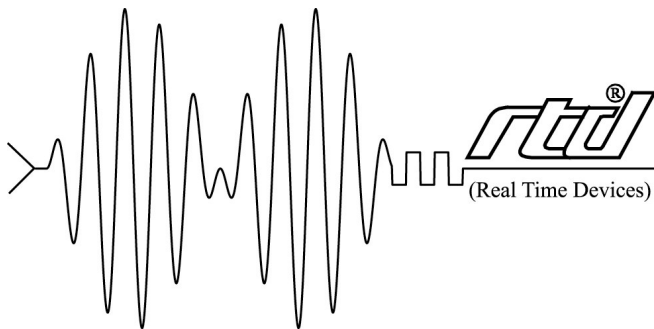

RTD Embedded Technologies, Inc.

"Accessing the Analog World"®

IDM-650010004
REVA

ISO9001 and AS9100 Certified

IDAN System Modules: Dimensions and Pinout

IDAN-DM6210-62S

12-Bit Analog I/O Module

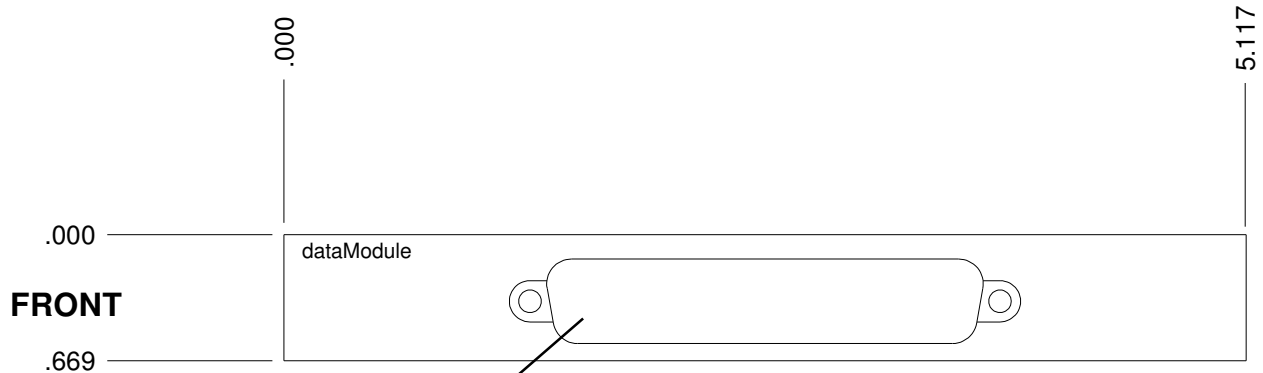

62 pin High Density "D": female

Module Part #: Adam Tech HDT62SD

Mating Part #: Adam Tech HDT62PD

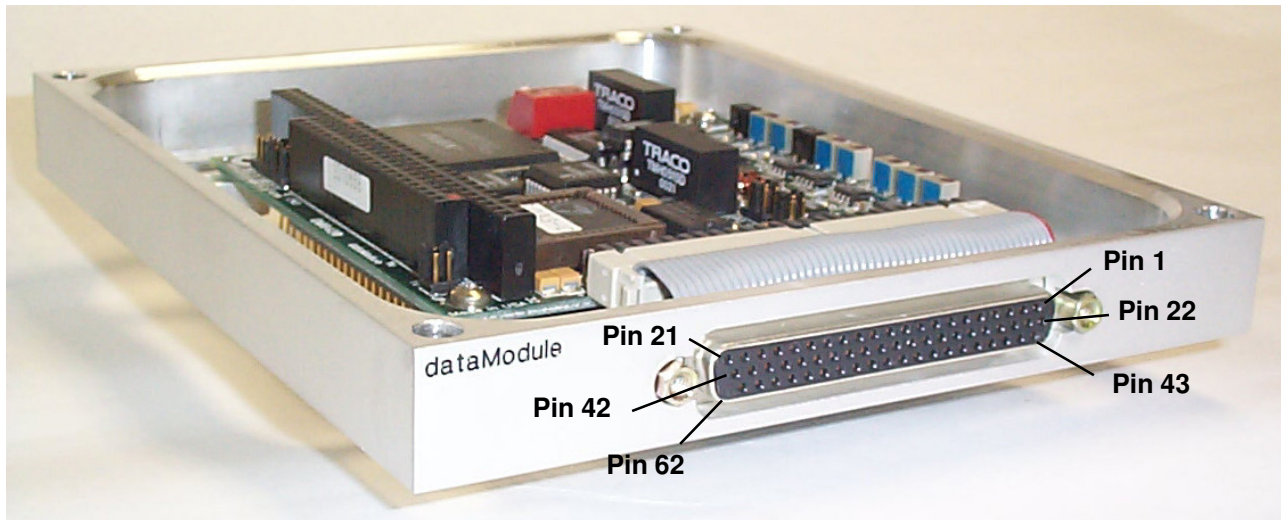

Drawing not to scale.

Copyright © 2003 by RTD Embedded Technologies, Inc.

All rights reserved.



For additional information:

Phone: 1 (814) 234-8087 ■ Fax: 1 (814) 234-5218

www.rtd.com ■ E-mail: sales@rtd.com

RTD Embedded Technologies, Inc.

"Accessing the Analog World"

IDAN System Modules: Dimensions and Pinout

NOTE: Do not make connections to reserved pins!!!

IDAN-DM6210-62S: 62 Pin High Density "D" Connector (Female)				
IDAN Pin #			Signal	DM6210 CN3 Pin #
Row 1	Row 2	Row 3		
1			AIN1	1
	22		AIN9	2
		43	AIN2	3
2			AIN10	4
	23		AIN3	5
		44	AIN11	6
3			AIN4	7
	24		AIN12	8
		45	AIN5	9
4			AIN13	10
	25		AIN6	11
		46	AIN14	12
5			AIN7	13
	26		AIN15	14
		47	AIN8	15
6			AIN16	16
	27		ANALOG GND	17
		48	ANALOG GND	18
7			EXT GATE 0	19
	28		ANALOG GND	20
		49	ANALOG GND	21
8			ANALOG GND	22
	29		P0.7	23
		50	P1.7	24
9			P0.6	25
	30		P1.6	26
		51	P0.5	27
10			P1.5	28
	31		P0.4	29
		52	P1.4	30
11			P0.3	31
	32		P1.3	32
		53	P0.2	33
12			P1.2	34
	33		P0.1	35
		54	P1.1	36
13			P0.0	37
	34		P1.0	38
		55	EXT CLK 0	39
14			T/C OUT 0	40
	35		EXT GATE 1	41
		56	T/C OUT 1	42
15			EXT CLK 1	43
	36		T/C OUT 2	44
		57	EXT CLK 2	45
16			EXT GATE 2	46
	37		+12 VOLTS	47
		58	+5 VOLTS	48
17			-12 VOLTS	49
	38		DIGITAL GND	50

Copyright © 2003 by RTD Embedded Technologies, Inc.
All rights reserved.



For additional information:

Phone: 1 (814) 234-8087 ■ Fax: 1 (814) 234-5218

www.rtd.com ■ E-mail: sales@rtd.com

RTD Embedded Technologies, Inc.

“Accessing the Analog World”